

1800 SERIES WATER METERS

ISTEC
Flow Measurement & Control



ISTEC's 1800 Series Single-Jet Water Meter in 1/2" and 3/4"



- Single Jet Design with only the impeller in the flow chamber for reliable performance
- Carbide Bearing for long lasting life
- Hermetically-sealed Counter is dust and waterproof, preventing internal condensation caused by temperature variations
- Roller Counter can be rotated for easy reading
- Built-in Reed Switch is cast into a waterproof enclosure and can be field replaced (Contact Rating 24V, 0.2A)
- Compact Design for easy installation
- Meter can be mounted horizontally or vertically

Model Number	1800	1805
Pipe Size	1/2"	3/4"
Horizontal Minimum Flow Rate (gpm)	0.13	0.22
Vertical Minimum Flow Rate (gpm)	0.3	0.4
Continuous Flow Rate (gpm)	6.6	11
Max. Flow Rate (gpm)	13.2	22
Max. Operation Temperature (°F)	248	248
Max. Operation Pressure (psi)	232	232
Design	Single Jet	Single Jet
Mounting Connections	NPT	NPT
Mounting Position	Horizontal or Vertical	Horizontal or Vertical
Pulse (gal/pulse)	1	1
Weight (pounds)	2.8	3.2

1800 & 1805 Dimensional Data

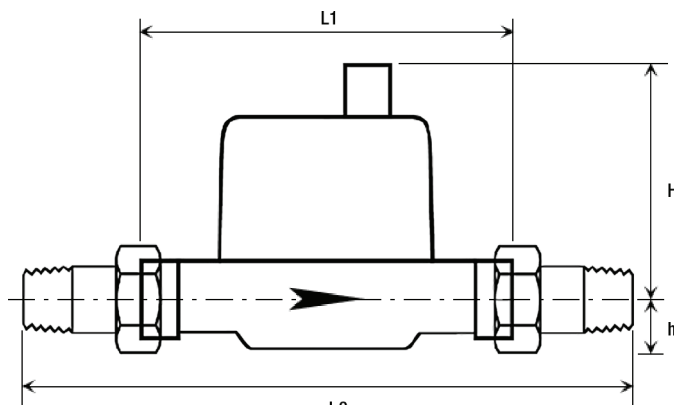

Dimensions	1800	1805
L 1	4-1/2"	5-1/4"
L2	9-1/4"	10-1/4"
H	3-3/4"	3 3/4"
h	3/4"	3/4"

Pressure Loss

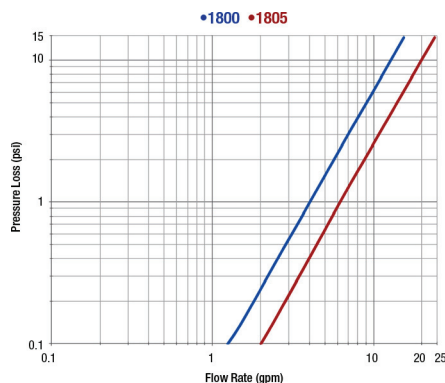

Typical Error

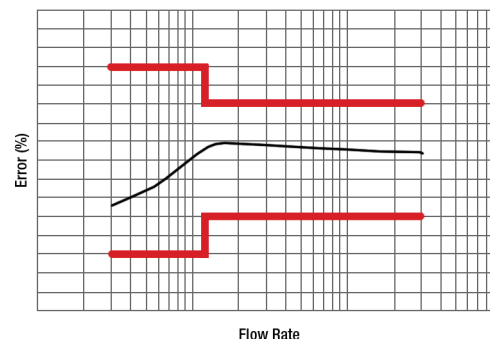

ISTEC's 1800 Series Multi-Jet Water Meter in 3/4" thru 2"



- Multi-Jet Design with only the impeller operating in the flow chamber for reliable performance
- No Straight Pipe required before or after the meter
- Hermetically-sealed Counter is dust and waterproof preventing internal condensation
- Roller Counter can be rotated for easy reading
- Built-in Reed Switch is cast into a waterproof enclosure and can be field replaced (Contact Rating 24V, 0.2A)
- Compact Design for easy installation
- Unique Design allows easy maintenance and repair
- Calibration Test Certification available on request

Model Number	1807	1810	1811	1812	1815	1816	1820
Pipe Size	3/4"	1"	1"	1"	1-1/2"	1-1/2"	2"
Min. Flow Rate (gpm)	0.22	0.4	0.4	0.4	0.7	0.7	2.64
Continuous Flow Rate (gpm)	11	26.4	26.4	26.4	44	44	66
Max. Flow Rate (gpm)	22	52.8	52.8	52.8	88	88	132
Max. Operation Temperature (°F)	248	248	248	248	248	248	248
Max. Operation Pressure (psi)	232	232	232	232	232	232	232
Design	Multi-Jet	Multi-Jet	Multi-Jet	Multi-Jet	Multi-Jet	Multi-Jet	Multi-Jet
Mounting Connections	NPT	NPT	NPT	NPT	NPT	NPT	Flanged
Mounting Position	U	H	D	U	H	D	H
Pulse (gal/pulse)	1	1	1	1	1	1	10
Weight (pounds)	5.25	7.5	8.1	8.1	14.2	15.5	27.5

H : Horizontal Installation, D : Vertical Downflow Installation, U : Vertical Upflow Installation

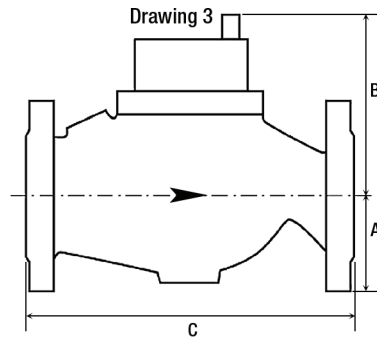
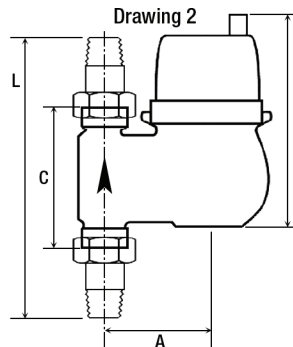
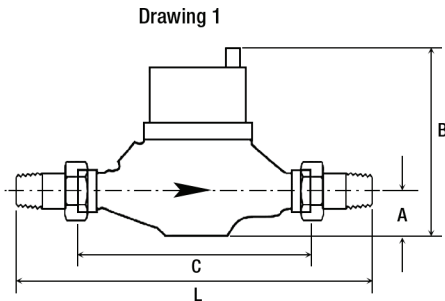

Dimensions	1807	1810	1811	1812	1815	1816	1820
Pipe Size	3/4"	1"	1"	1"	1-1/2"	1-1/2"	2"
A	3-1/4"	2"	3-3/4"	3-3/4"	2-1/4"	4-3/4"	3-1/4"
B	6-1/2"	7"	7-1/4"	7-1/4"	8"	8-1/4"	6-1/4"
C	4-1/4"	10-1/4"	6"	6"	11-7/8"	8"	10-1/2"
L	9-1/4"	15-1/2"	11-1/4"	11-1/4"	17-1/2"	13-3/4"	N/A
Drawing	2	1	2	2	1	2	3

See Next Page for Pressure Loss and Accuracy

ISTEC's 1800 Series Multi-Jet Water Meter in 3/4" thru 2"

Pressure Loss

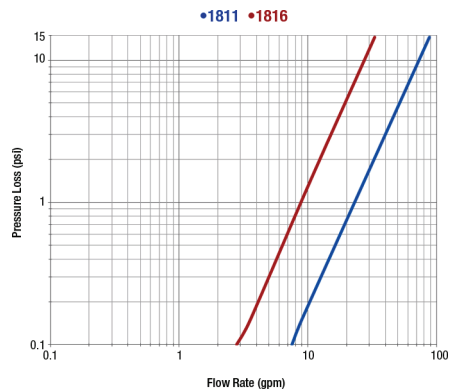
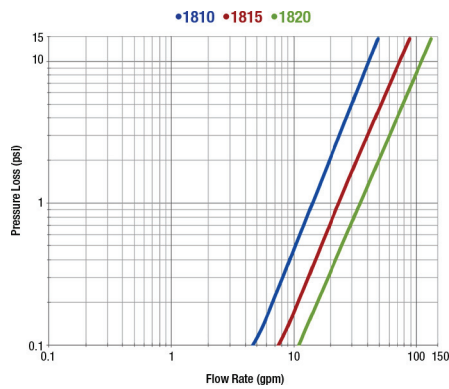
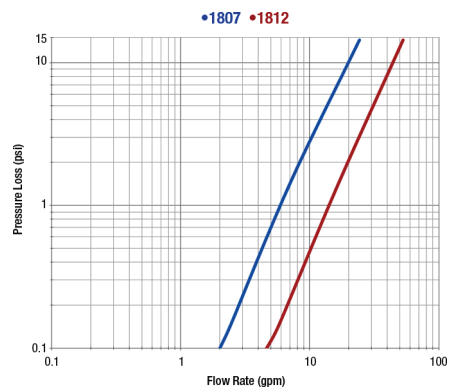

Accuracy

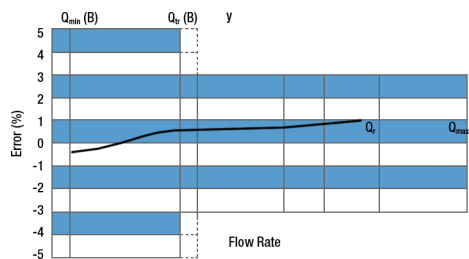

ISTEC's 1800 Series Woltmann Design Water Meter in 2" thru 6"

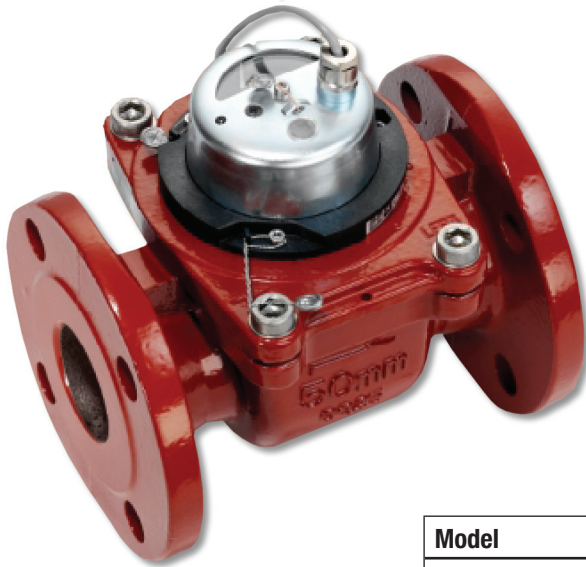

- Woltmann (Flow Chamber) Design with only the impeller operating in the flow chamber for reliable performance
- Very low Head Pressure loss
- Installation in Horizontal or Vertical positions
- Hermetically-sealed Counter is dust and water proof preventing internal condensation
- Roller Counter can be rotated for easy reading
- Built-in Reed Switch is cast into a waterproof enclosure and can be field replaced (Contact Rating 24V, 0.2A)
- Compact Design for easy installation
- Field Replaceable Flow Chamber is factory calibrated

Model	1825	1830	1835	1840
Pipe Size	2"	3"	4"	6"
Min. Flow Rate (gpm)	2.6	14.1	8.8	35
Continuous Flow Rate (gpm)	66	140.9	264	880.6
Max. Flow Rate (gpm)	264	396.3	792.5	1320.9
Max. Operation Temperature (°F)	248	248	248	248
Max. Operation Pressure (PSI)	232	232	232	232
Design	Woltmann	Woltmann	Woltmann	Woltmann
Mounting Connections	Flanged	Flanged	Flanged	Flanged
Mounting Position	Horz or Vert	Horz or Vert	Horz or Vert	Horz or Vert
Pulse (gal/pulse)	10	10	10	100
Weight (pounds)	25	31	48	88

1800 Series Dimensions

Dimensions	1825	1830	1835	1840
Pipe Size	2"	3"	4"	6"
A	5-1/2"	5-1/2"	8-1/4"	9"
B	3"	3-3/4"	4-3/8"	5-3/4"
C	7-7/8"	8-7/8"	9-7/8"	11-7/8"

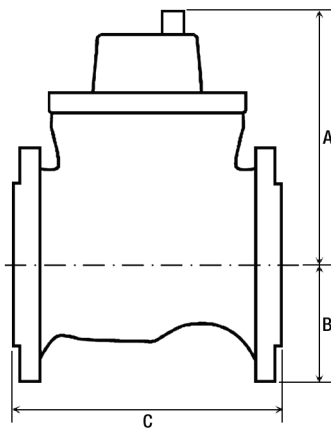

Pressure Loss

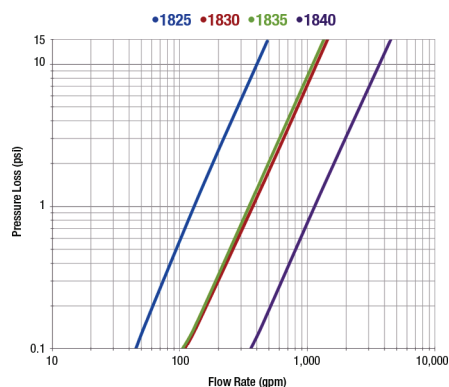

Accuracy

