

# SUBMITTAL

v.1

**Manufacturer:** Actaris  
(formerly Schlumberger)  
**Model:** RB1700

As Specified	
Capacity Required	
Inlet /Outlet Pres.	
Overpres. Limits	

As Submitted	
Capacity	
Droop	
Build-up	

**Options Designations:**

<input type="checkbox"/> -10: Low Pressure No Internal Relief
--

<input type="checkbox"/> -20: Mid-Pressure No Internal Relief
--

<input type="checkbox"/> -30: High Pressure No Internal Relief
---

**Specifications:**

Spring Color	RB1710	RB1720	RB1730
	(14" Diaphragm)	(8" Diaphragm)	(8" Diaphragm)
Yellow	6.8 – 9.2" w.c.	-	-
Red	8.4 – 12.8" w.c.	-	-
White	10.9 – 21.2" w.c.	-	-
Purple	0.3 – 1.4 PSIG	1.9 – 5.3 PSIG	-
Orange	1.2 – 3.0 PSIG	2.9 – 8.7 PSIG	-
Brown	-	4.4 – 9.4 PSIG	7.3 – 14.5 PSIG
Green	-	5.8 – 13.0 PSIG	8.7 – 19.5 PSIG
Black	-	-	11.6 – 21.7 PSIG
Grey	-	-	16.0 – 36.0 PSIG

Connections (NPT)	
Inlet	Outlet
1 1/2"	1 1/2"

**Assembly:**

Valve Body	Ductile Iron
Orifice:	Stainless Steel
Valve Seat:	Brass w/ vulcanized Buna-N
Valve Stem:	Stainless steel
Valve Stem Bushing	Nylon
"O"-ring Seals	Buna-N nitrile rubber
Diaphragm:	Buna N & nylon reinforcing mtl.
Adjustment screw:	Brass
Diaphragm case	Stamped Steel

**Dimensions:**

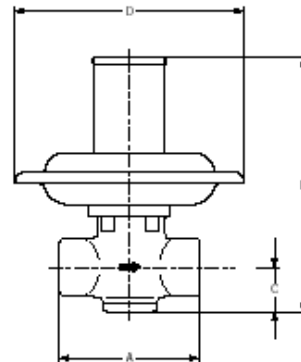

	A	B	C	D	Vent	External Sense Line	Weight Lbs.
1710	5.9"	15.7"	"	12 3/4"	1/4"	1/4"	33
1720, 1730	10"	5"	8 11/16"	12 3/4"	1/4"	1/4"	28

**General Note on installation:** The regulator comes with a 1/4" vent with a stainless steel vent screen. On outside installations, fittings should be used to point vent opening down to keep water or ice from entering vent. . If installed inside, vent must be piped to a safe outside location in accordance with NFPA 54 recommendations and/or local codes. The regulator does not have over-pressure protection. If overpressure protection is required, use two regulators in series (operator/monitor) or use an external relief valve. The regulator also uses a 1/4" sensing line which should be connected downstream in a section of straight unobstructed pipe. See detailed instructions for examples.

**Typical Capacity.**

Note: Capacity will change as a function of the inlet pressure & outlet pressure setting. The capacity tables below are for a typical configuration: a 1.5" Regulator, with 1 1/8" orifice. Outlet pipe size\* and length may also reduce flow. If installed in operator/monitor fashion, capacity will be reduced by 30%. Consult complete product bulletin for capacities.

Set Point	Capacity as a Function of Inlet Pressure & Set Point in SCFH				
	14" w.c.	1 PSIG	2 PSIG	5 PSIG	10 PSIG
7" w.c.	3700	6000	9000	15000	26000
11" w.c.	3600	5500	9500	16000	24500
14" w.c.		5300	9200	15300	23600

The RB1700 is compliant with ANSI and AGA-GAMA standards

Capacities expressed for 0.6 s.g. nat. gas, \*Max capacity for 1 1/4" outlet pipe: 2500 SCFH, 1 1/2" pipe: 7500 SCFH, 2" pipe: 10,000 SCFH